

E38-3E系列日夜帘电机说明书

公司保留更改产品设计与说明书的权利，届时将不另行通知，图片仅供参考，具体以实物为准。 A/O H12172

产品简介

日夜帘电机



正面

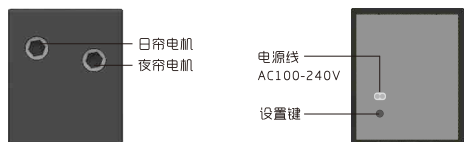

左面

右面

控制系统



操作说明 (*以A13按键发射器为例进行说明，其它发射器请参考相应的发射器说明书。)

对码： 重复操作对码步骤即是消除当前码。一台电机最多存5个遥控码，再增加遥控器只会覆盖第一个：

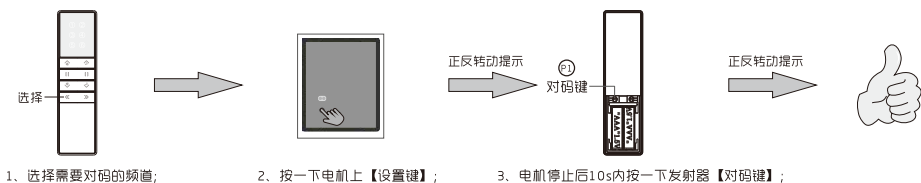

复制： 为已经对码的电机新增加一个B发射器：

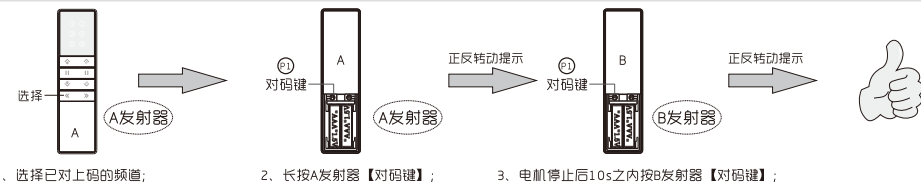

遥控设置上下行程： ⚠️ 必须先设上行程，再设下行程，重复操作将会覆盖当前行程，30s内无操作自动退出设置状态：

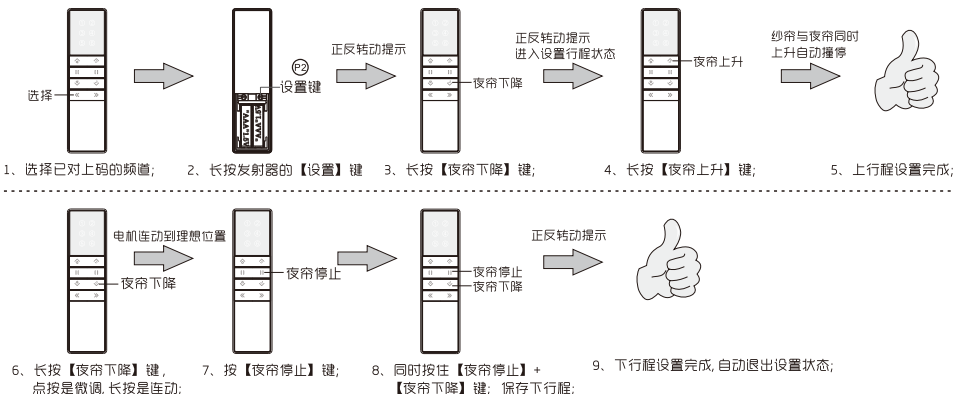

喜爱位置： 定好上、下行程才有效：

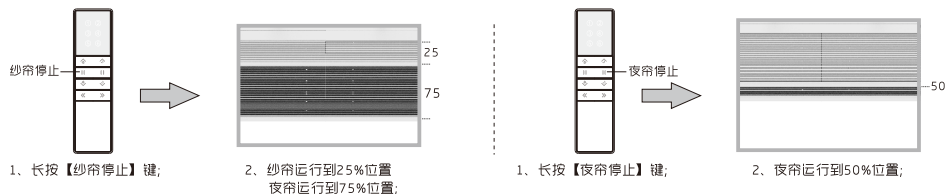

日夜帘上升间隙模式调整(升旗式)： 出厂默认认为大间隙模式，重复操作是大间隙与零间隙相互切换：

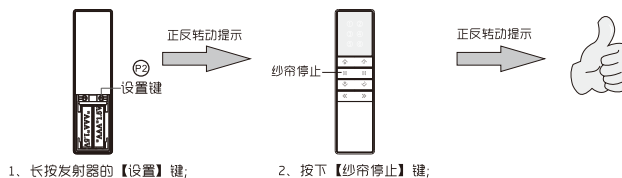

恢复出厂设置： 清除电机上所有接收储存发射器的记忆，包括清除行程：

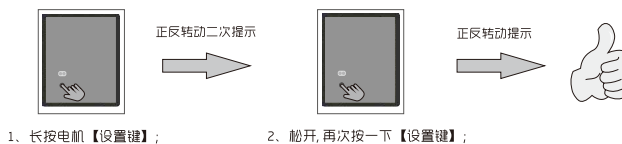

38-3E Day Night Blinds Motor Operating Manual

Company reserves the right to change product design and specifications without prior notice then, photos are for reference only. A/0 H12172

Product Introduction

Day Night Blinds Motor



Front

Control System

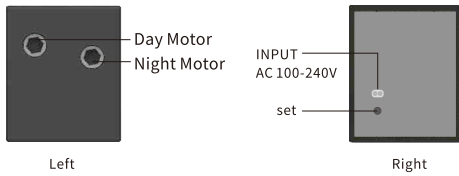
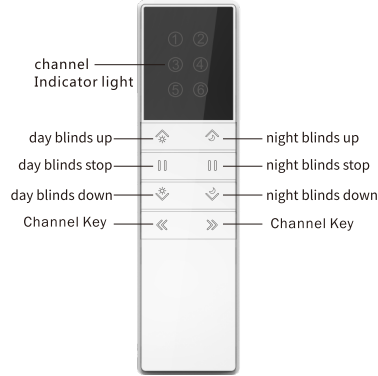

Left

Right

Instructions: (Take A13 button transmitter as an example, for other transmitters, please refer to the corresponding transmitter manual.)

Pairing transmitter and motor: repeat the pairing operation once to eliminate the current pairing. A motor stores up to 5 transmitter channels, adding a new transmitter channel will cover the earliest channel. For example, current paired channels are 1-5. If you add channel 6, paired channels will be 2-6.

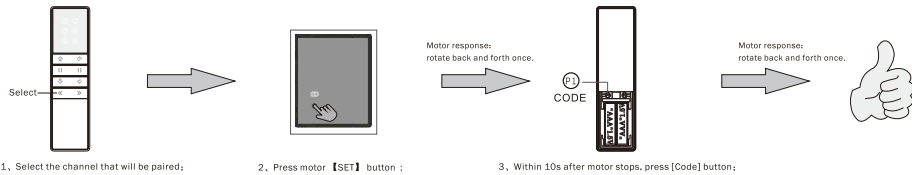

1. Select the channel that will be paired;

2. Press motor [SET] button ;

3. Within 10s after motor stops, press [CODE] button;

copy add a new channel to control motor. (No need to touch motor)

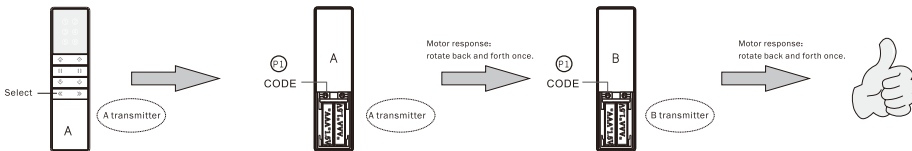

1. Select the channel that will be copied;

2. Press & Hold [code] button on transmitter about

3. Within 10s after motor stops, press [code] button on B transmitter

Use remote to set up and down limit ⚠ Have to set up limit firstly, then set down limit. If no actions within 30 seconds, motor will quit limit setting state.

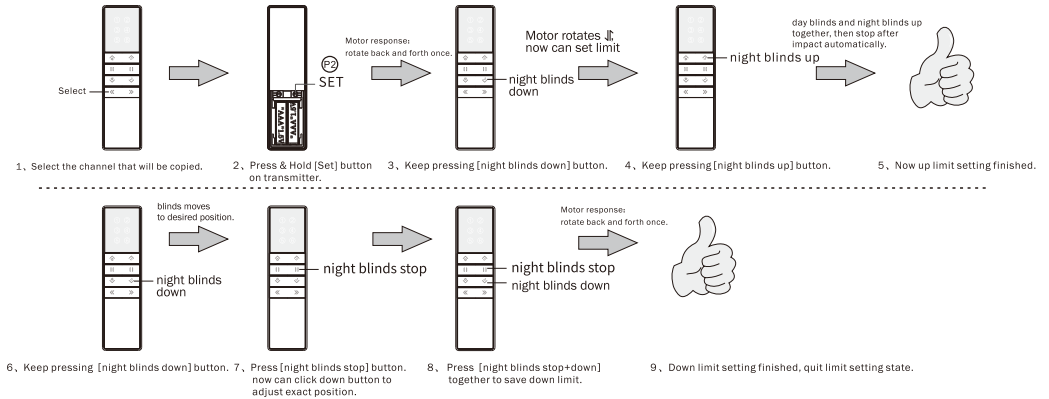

Favorite position Firstly must finish setting up and down limit

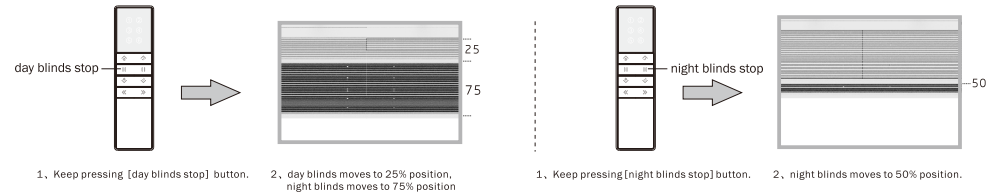

Day and night blinds rising gap mode adjustment (flag-raising type) The default is the large gap mode. Repeated operations will switch between large gap and zero gap.

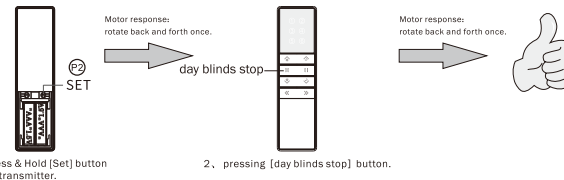

1. Press & Hold [Set] button on transmitter.

2. pressing [day blinds stop] button.

Restore factory settings Clean all paired codes from remote and all limits.

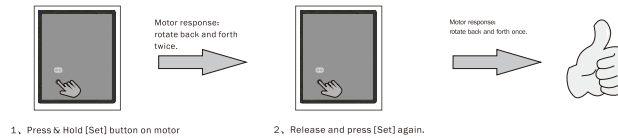

1. Press & Hold [Set] button on motor

2. Release and press [Set] again.